

PREFERRED SHIPYARD DELIVERING SOLUTIONS



شركة ناقلات كيبيل للأعمال البحرية المحدودة
Nakilat - Keppel Offshore & Marine Ltd

Erhama Bin Jaber Al-Jalahma Shipyard



COMPANY OVERVIEW

Established in 2007, Nakilat – Keppel Offshore & Marine Limited (N-KOM) is a joint-venture between Nakilat, the world's leading transporter of Liquefied Natural Gas (LNG), and Keppel Offshore & Marine, the global leader in ship repair, ship conversion & construction of offshore drilling rigs.

The shipyard was inaugurated on 23 November 2010 as part of the Erhama Bin Jaber Al Jalahma Shipyard complex.



OUR VISION

To be a leader in delivering unique value in Marine & Offshore services.



OUR MISSION

As N-KOM, we aim to exceed customers expectations by providing a safe, high quality and effective Maritime Fabrication and Repair service leveraging on our expertise, dedication and world-class facility.

We actively contribute to Qatar Vision 2030, playing a strategic role in the country's energy value chain and supporting the local economy expansion, through continuous human capital development and environment preservation.



OUR VALUES

Safety: Every day, we create an Incident-free workplace, taking care of each other, honouring our safety and environmental responsibilities.

Collaboration: We actively support all N-KOM members and external parties. Teamwork to us means listening carefully, acting quickly and guiding openly.

Passion: We have high energy to pursue continuously our goals. We love our work and look continuously to do it better.

Integrity: We continuously build trust, transparency and respect with each N-KOM employee and external party. We believe in the respect of rules for the benefit of all.

Commitment: At every level we take ownership and accountability. We invest in our people and community. We are proactive, productive and we deliver.

SN	NAME / DESCRIPTION	WIDTH (m)	LENGTH (m)	AREA (m ²)
1	Production Support Facilities	30	75	2,250
2	Parking / Scrap / Weighbridge	30	80	2,400
3	Repair Berths (Vessels up to 75m x 15m) / Laydown Area	132	155	20,460
4	Wash-Down Area	50	80	4,000
5	Repair Berths (Vessels up to 35m x 85m)	77	132	10,164
6	75m x 15m x 1100 TLC Travelift (Mobile Boat Hoist)	-	-	-
7	35m x 8.5m x 300 TLC Travelift (Mobile Boat Hoist)	-	-	-
8	Pier No. 2A	22	327	-
9	120,000 TLC (Q-MAX) Floating Dock	66	375	-
10	Inflammable Goods Store No. 1	15	30	450
11	Subcontractors' Facility / Amenity Block "A"	30	120	3,600
12	Stores & Support Facility	130	120	15,600
13	Main Amenity Block "B" (3 Floors)	30	120	10,800
14	M & E Facility	80	120	9,600
15	Quay No. 1	22	367	-
16	Pier No. 1	22	405	-
17	Contaminated Water Treatment Plant	25	55	1,375
18	Dry Dock No. 1	66	360	23,760
19	Dry Dock No. 2	80	400	32,000
20	Main Office Building (6 Floors)	30	120	21,600
21	Pipework Facility	95	120	9,570
22	Plate & Section Stockyard	60	120	7,200
23	Treatment line (Pre-heat / Shotblast / Prime / Dry / Mark)	10	40	400

SN	NAME / DESCRIPTION	WIDTH (m)	LENGTH (m)	AREA (m ²)
24	Steelwork Facility	130	120	15,600
25	Blast & Paint Cells	54	35	1,890
26	Mobile Shelter	-	-	-
27	Pier No. 2	22	371	-
28	Quay No. 2	22	401	-
29	Amenities Block "C" (2 Floors)	25	70	3,500
30	Utilities Compound (Central)	65	95	6,175
31	Depot Store	130	120	15,600
32	Assembly Shop	130	180	23,400
33	Construction Hall	85	270	31,950
34	Pier No. 3	22	275	-
35	Superyacht Hall	100	150	15,000
36	Unloading quay	25	150	-
JIB CRANES				
100T: JC-3, JC-6, JC-12, JC-21				
30T: JC-1, JC-2, JC-4, JC-5, JC-7, JC-8, JC-10, JC-11, JC-22				
50T: JC-9				

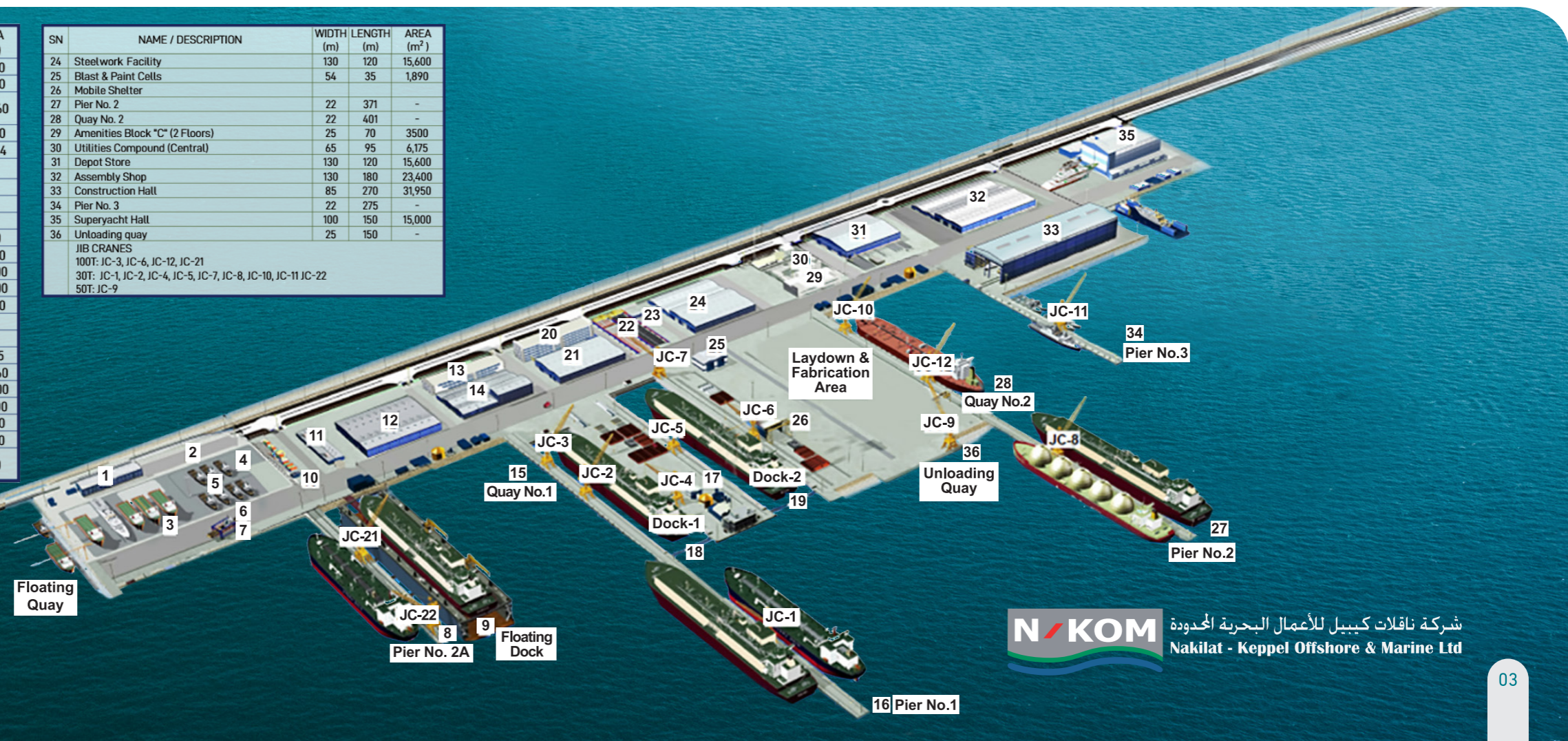

FACILITIES & CAPABILITIES

SHIPWRIGHT

Main Operations:

- **Marine Movement:**
 - Docking & undocking of vessels, rigs & barges
 - Lifting of tugs & barges using MBH 300 & 1100
 - Cranes & davits testing
- **Blasting & Painting:**
 - Surface preparation & coating of vessel refits and newbuild structures
 - Blasting Chamber activities, Waste management (disposal of used abrasives)
- **Scaffolding:**
 - Erection, modification & dismantling of scaffolding
- **Tank Cleaning:**
 - FOT, Sludge tank, Chain lockers, Sump tank, Bilge holding tank, Sewage tanks waste management (oily water & sludge disposal), Perlite extraction & refilling
- **Afloat Services:**
 - Spares & supplies delivery to vessels at Anchorage & RLIC berth by Supply Boat (Falcon 1) & Assisting crew change activities



PIPING

Pipework facility
 Ferrous workshop: 3,600m²
 Non-Ferrous workshop: 3,000m²
 Semi-auto & Manual pipe fabrication: 1,500m²
 Total of 14 cranes: 3 x 10T, 2 x 5T, 9 x 2.5T
 Stockyard Crane: 1 x 5T

Main Operations:

- Pipe profile-cutting & beveling with both Fuel gas & Plasma
- Cold cutting & beveling
- Cold bending
- Pipe threading
- Cold rubber lining
- Pressure testing
- Exotic pipe fabrication & welding
- Non-Destructive Testing (NDT) - Radiography
- Pipe & Fittings fit-up robotic welding station
- Piston Crown & Cylinder head build-up welding



STEELWORK

Steel Plate Stockyard
 Ferrous: 3,600m²
 Non-Ferrous: 3,000m²
 Semi-auto & Manual Pipe Fabrication: 1,500m²
 Total 4 Magnetic Cranes: 2 x 15T, 2 x 10T
 Stockyard Crane: 1 x 15T

Main Operations:

- Steel Renewal & Outfitting jobs on repair vessels
- CNC Plate & Profile-cutting jobs
- Bending, Rolling, Pressing, Punching, Shearing & T-beam Fabrication jobs
- IMG Line: Panel Fabrication & SAW Boom Welding
- Fabrication of Offshore & Onshore structures



ELECTRICAL

Electrical Workshop: 2,400m²
 Cranes: 2 x 10T

Main Operations:

- Electrical Motors overhauling
- Switchboard servicing
- Alternators overhauling
- Air Circuit Breaker (ACB) overhauling
- Cable laying, Pulling & Termination



MECHANICAL

Machinery Workshop: 7,200m²
 Total of 6 cranes: 4 x 15T, 1 x 20T, 1 x 50T
 Cryogenic Cleanroom: 390m²
 Crane: 1 x 10T

Main Operations:

- **Machinery / Cryogenic Workshops:**
 - Winch & cargo tank repair, testing, repair & overhauling of Air cooler, Brake bands, Crude Oil Washing machines, Cargo Oil Pump Turbine rotor, Hydraulic (Rams & Motor), Forced Draft & Air Handling Unit Fan, Valves (Pressure Vacuum, Safety, Cryogenic, Steam & Sea), Pumps (Engine fuel, Centrifugal/Screw type), Sheaves, Windlass & Mooring winch drum, Auxiliary and Main engine piston & cylinder head, LPG cargo pump, Propeller shaft Blue fit, Single Buoy Mooring Swivel bearing and Stern tube seal
- **Afloat Repairs & Dock Works:**
 - Removal/refit of Propeller, Rudder, Deck crane, Windlass & Mooring winch drums, Draft gauge & Cryogenic valves, Fuel, Cargo & Spray Centrifugal/screw type pumps, Cargo & Boiler valves, Heat exchangers (plate & tube type) & M/E air cooler
 - Overhauling of Brake bands, Fairlead rollers, Sheaves, Compander, Valves (Sea, Ballast, Storm & Safety) and M/E units
 - Repair and Works on Boiler bellow/burner/tube, BWTS, Rudder, Stern tube seals, Intermediate shaft, Turbine and Boiler & Economizer cleaning/washing



Value-added Services and Solutions

BWTS Turnkey Solutions

- ◆ Detailed Engineering Solutions for BWTS using 3D Modeling Software

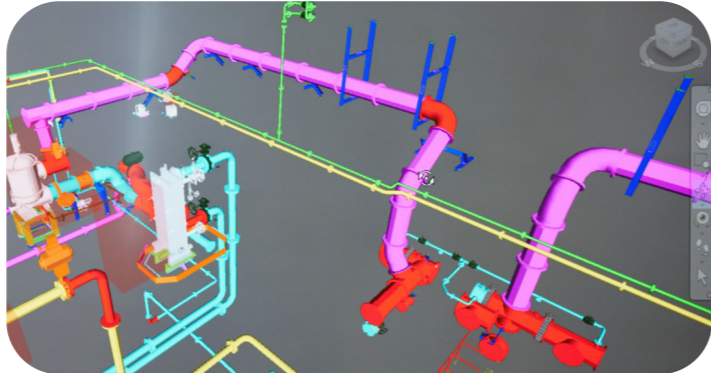

N-KOM and ABS Joint Development Project (JDP)

- ◆ N-KOM & ABS will jointly explore the development of Remote Survey Techniques to augment Shipyard Surveys & Inspections



PROJECTS SHOWCASE (MARINE)

MAIN ENGINE GAS INJECTION (ME-GI)

May 2015 - Successfully executed the world's first ME-GI (Main Engine Gas Injection) conversion of a Nakilat Q-Max LNG carrier, Rasheeda, to use LNG as an alternative fuel in the main engine.



FLOATING STORAGE REGASIFICATION UNIT (FSRU) CONVERSION PROJECT

March 2019 - Successfully completed the first FSRU conversion project including BWTS installation, Refit and Upgrades for the 138,000 cubic meter Excelerate vessel owned by Excelerate Energy (USA).



PROJECTS SHOWCASE (OFFSHORE)

BUL HANINE REDEVELOPMENT PROJECT

October 2019 - Successfully completed Bul Hanine Redevelopment (Phase B) for QatarEnergy comprising Fabrication of Topside (730MT), Offshore Jacket/Piles (845MT), Deck extension (270MT), Subsea piping spools, Subsea valve skids & Brownfield Works (55MT).



NFB ACCOMMODATION EXPANSION PROJECT

February 2020 - Successfully delivered the first major Living Quarters (LQ) Topside fabricated & commissioned in Qatar for Qatargas comprising LQ Topside (2800MT), 4-legged Jacket/Piles (2100MT) & 5 built-in bridges.



Nakilat – Keppel Offshore & Marine Ltd. (N-KOM)
Southern Breakwater, Ras Laffan Industrial City
P.O. Box 28388, State of Qatar

Phone: +974 4419 7442
Email: commercial@nkom.com.qa

 | www.nkom.com.qa